

Timberlea, Prospect, St. Margaret's Bay

## Highway 333

\$349,900



### **Ernie Buote, FRI**

Domus Listing Agent

[ernieb@domus.ns.ca](mailto:ernieb@domus.ns.ca)

902-499-3041

---

## Description

A NOVA SCOTIA DEVELOPMENT OPPORTUNITY, 17.40 ACRES OF UNDISTURBED ACREAGE WITH OCEAN FRONTAGE. Land registration has been completed, this property is ready for the dream to come true.

---

## Specifications

MLS <sup>®</sup> Number	202504052
Class	Vacant Land
Type	Acreage
Water Source	None
Sewage Disposal	None

---

## Location



# Photos

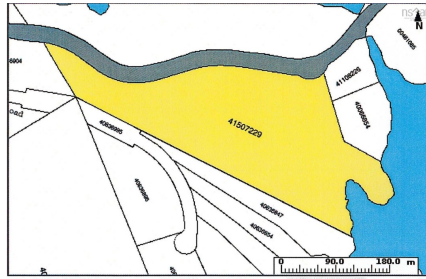

Lat: 44-30-42N Long: 63-52-29W Scale: 4389 Zoom: 2

